

# CAREER & LIFE EDUCATION



Project Discovery™

**HEAR IT.**

**SEE IT.**

**DO IT.**

Discover a world of real life opportunities for every one of your students



**INCLUDING 17 TITLES  
FOR INDIVIDUALS WITH  
AUTISM AND OTHER  
DEVELOPMENTAL  
DISABILITIES**

# QUESTIONS?

We have the answers.

What's the best way to teach students with autism or other developmental disabilities Career and Life Skills?



## RESEARCH SHOWS THAT EVIDENCE-BASED PRACTICES ARE THE MOST EFFECTIVE

**Project Discovery** offers a full complement of evidence-based practices built into its curriculum specifically designed to set students up for success.

Will my students have the opportunity to practice job skills with real tools?



## RESEARCH SHOWS THAT YOU SHOULD CONNECT ACTIVITIES TO REAL-LIFE EXPERIENCES

**Project Discovery's** career curriculum includes real tools for real job tasks students would experience on the job.

How can behavior issues be minimized when teaching career education?



## RESEARCH SHOWS THAT MANY BEHAVIOR ISSUES OCCUR DUE TO DEFICITS IN COMMUNICATION

**Project Discovery** includes communication supports and a predictable order of implementation which supports behavior challenges. (First look, student instructions, video modeling, live modeling, visual schedules)

## PROJECT DISCOVERY IS RESEARCH BASED: APPROVED & VALIDATED

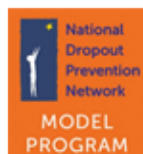

**JUST LOOK INSIDE FOR MORE!**



## INTRODUCING...

A dynamic hands-on career education program specifically designed to provide individuals with autism and other developmental disabilities the opportunity to explore careers, learn about their passions and interests, and gain work and life ready skills.

- Adapted curriculum ideal for low-functioning students with moderate to severe challenges
- Includes two levels of instruction: Adapted and general curricula
- Bridge to community employment and post-secondary options

Research shows certain evidence-based practices are effective teaching strategies for students with autism and other developmental disabilities.

### EVIDENCE-BASED PRACTICES

1. Video Modeling
2. Systematic Instruction
3. Visual Supports
4. Progress Monitoring and Performance Evaluation
5. Social Communication and Behavior Activities
6. Hands-On Instruction
7. Differentiated Instruction (Universal Design for Learning)
8. Academic Standards & Alternate Assessments
9. Correlations to Standards

Project Discovery incorporates these strategies throughout the program to help teachers have a positive impact in the lives of their students.

### PROJECT DISCOVERY OFFERS

1. Video Modeling of all activities in the kits
2. Student Instructions utilizing System of Least Prompts and Constant Time Delay
3. Visual Schedules and Real Life Photos throughout
4. Data Sheets
5. Role plays, situation cards, bingo and vocabulary boards
6. Hands-on activities utilizing real tools
7. Multiple means of representation, expression and engagement
8. Assessments and integrated academics
9. Correlated to Common Core State Standards and Alternate Assessments

## DIFFERENTIATED INSTRUCTION

## PRACTICE MAKES PERFECT!

It's important to provide ways to practice job skills

100s of Hands-on Activities

Real tools

50+ Videos



Hands-On



Video



Audio



Print



Personal Devices



Interactive Whiteboard

## VIDEO MODELING

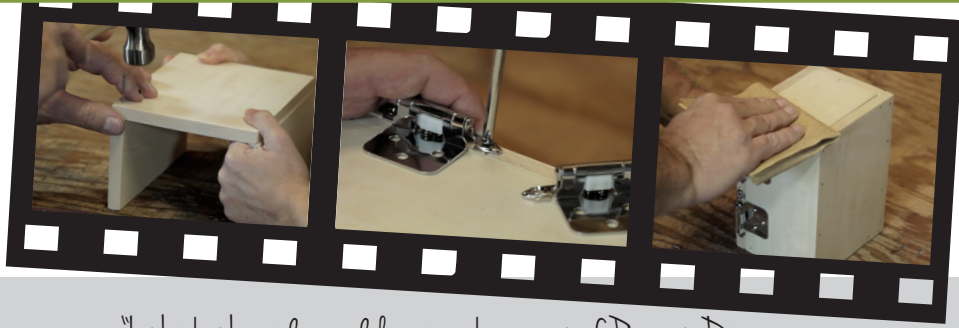

**PROVIDES VISUAL AND AUDITORY SUPPORT FOR STUDENTS TO COMPLETE ACTIVITIES.**

With this highly motivating, consistent method of presentation, students know what to expect and it helps them stay on task!

Research shows video modeling is effective for teaching social and functional skills.

*"I think the video modeling is a key part of Project Discovery that other functional programs overlook."*

Elena Hitch, Special Education Instructor, Woodford Co. HS, KY

## SYSTEMATIC INSTRUCTION

**STRUCTURED APPROACH WHERE PROMPTS ARE EMBEDDED INTO THE CURRICULUM TO ELICIT NEAR ERRORLESS LEARNING.**

The **System of Least Prompts** is included to teach chained behaviors as tasks are broken into single steps with a prompt hierarchy to help ensure success. **Constant Time Delay** is used to teach discrete behaviors such as vocabulary.



*Help students progress toward independence!*

*Project Discovery supports Universal Design for learning with...*

- Multiple means of representation, expression and engagement!
- Flexible instructional strategies

## VISUAL SCHEDULE & REAL-LIFE PICTURES

Setting a Table Visual Schedule		When Done
Name: _____	To Do:	
1. Gather all materials.		
2. Wash your hands.		
3. Wipe the table.		
4. Place the placemat on the table.		
5. Put plate on the placemat to match the picture.		
	13. Get a bus tub and put all the dishes in it.	
	14. Put all the things away.	
	15. Wipe the table.	
	16. Wash your hands.	
	How did I do?	
	<input type="radio"/> 😊 <input type="radio"/> 😐 <input type="radio"/> 😞	
	Did you like setting the table? <input type="radio"/> 😊 <input type="radio"/> 😐 <input type="radio"/> 😞	

**SKILLS WITHIN A CHAINED TASK ARE DEPICTED VISUALLY STEP BY STEP WITH REAL-LIFE PICTURES TO SUPPORT TIME ON-TASK.**

Visual Schedules promote independence and support the person with social and behavior issues by allowing the individual to know exactly what is expected in any given activity.

*Gauge student interests*

# PUTTING EVIDENCE-BASED PRACTICES TO WORK IN THE CLASSROOM

## PROGRESS MONITORING & PERFORMANCE EVALUATION

**DATA SHEETS PROVIDE A DETAILED TASK ANALYSIS FOR EACH ACTIVITY.**

Use to effectively record and track the use of prompts and the student's performance and progress toward completion of tasks.

Using a Screwdriver and Screws Data Sheet

Name: \_\_\_\_\_

Condition (Baseline or Intervention) \_\_\_\_\_

Step: \_\_\_\_\_ Date: \_\_\_\_\_

1. Gather the materials you need.
2. Put the materials on the table.
3. Put on your safety goggles.
4. Make sure you have the right screwdriver for your screws.
5. Put screw point into hole in wood.
6. Carefully turn screwdriver until screw goes into wood.
7. Have your teacher check your work.
8. Clean up your work area.

Number Independent \_\_\_\_\_

Number Points Earned \_\_\_\_\_

How did I do?

Did you like using a screwdriver and screws?

Key: I=Independent; G=gesture; A=auditory/verbal; V=visual/point; PP=partial physical; FP=full physical; 0=no response (this would be baseline only)

Points earned: I=6; G=5; A=4; V=3; M=2; PP=1; FP=0

Document student interest...

...and performance!

## SOCIAL COMMUNICATION & BEHAVIOR ACTIVITIES



**MULTIPLE PROGRAM COMPONENTS SUPPORT COMMUNICATION NEEDS**

...such as vocabulary boards and cards, role playing, games and situation cards, all centered around the career areas.

Project Discovery's predictable order of implementation and visual supports increase appropriate behaviors and independence.

Digital files provided for easy import into communication devices or to customize as needed.



Students practice real job world scenarios!

## ACADEMIC STANDARDS

**TO REDUCE TEACHER PREPARATION TIME, THE LESSONS ARE ALIGNED TO SUPPORT ACADEMIC STANDARDS.**

English/Language Arts are integrated into the program such as...

- Vocabulary boards
- Matching
- Writing
- Reading/listening to task instructions

Math activities are included with functional academic worksheets such as...

- Addition
- Subtraction
- Multiplication
- Plane Geometry
- Missing Variables
- Using Money
- Sequencing and Pattern Development

Science activities include such topics as...

- Taking Temperature/Pulse
- Taking Measurements
- Practicing Cleanliness Techniques
- Safety Procedures

Worksheet 18

NAME: \_\_\_\_\_

Directions: Each toolbox has \_\_\_\_\_ screwdrivers.

There are  toolboxes.  screwdrivers.

How many screwdrivers are there in all? \_\_\_\_\_

X  = \_\_\_\_\_

CARPENTRY

61.7%

CHILD CARE

PRE-POST TEST SCORES SOAR!

55.3%

TABLE SERVICE

AVERAGE PERCENT INCREASE FOR ALL PARTICIPANTS



"Student puts three words together for the **first time ever.**"

# BE INSPIRED BY THEIR STORIES AND EXPERIENCES

"Each kit offers activities that utilize multiple means of **representation, expression and engagement.**"

"They found the curriculum beneficial to more than just career exploration, such as learning **life ready skills** for at home use."

"Students began **seriously thinking about potential jobs** as a result of the career activities."



SENIOR PROJECT DEVELOPER  
**AMY SPRIGGS, Ph.D.**

AUTISM AND SEVERE DISABILITIES EXPERT  
UNIVERSITY OF KENTUCKY

"We are so excited that our Beta sites' test scores are showing **double digit increases** and **skill levels have dramatically improved!**"

CONTACT US OR VISIT OUR WEBSITE FOR A FREE COPY OF THE RESEARCH REPORT.

Request a preview packet and be entered in our drawing to win a **FREE** multimedia title!  
SEE WEBSITE FOR MORE DETAILS



**Project Discovery™**  
Job Ready. Life Ready.



Let's Get Social | [iLoveProjectDiscovery.com](http://iLoveProjectDiscovery.com) | [info@EducationAssociates.com](mailto:info@EducationAssociates.com)